



SHOPS AT SAVANNAH BRANCH

HIGHWAY 17, LELAND, BRUNSWICK COUNTY, NC 28451

PROPERTY HIGHLIGHTS

- » Brunswick County is one of the fastest growing counties in North Carolina, with growth concentrated in the Leland area
- » Average household income of \$104,541 within a 1-mile radius



120,162 SF



26,500 AADT



FEATURED AVAILABILITIES:

- » Junior Anchor Space Available
- » Outparcel 1 - 1.20 AC
- » Outparcel 2 - 1.21 AC

Kris Murphy
 P: 678.460.3122
 E: kmurphy@columbiapropertiesinc.com
 www.columbiapropertiesinc.com



COLUMBIA PROPERTIES



COLUMBIA RETAIL MANAGEMENT

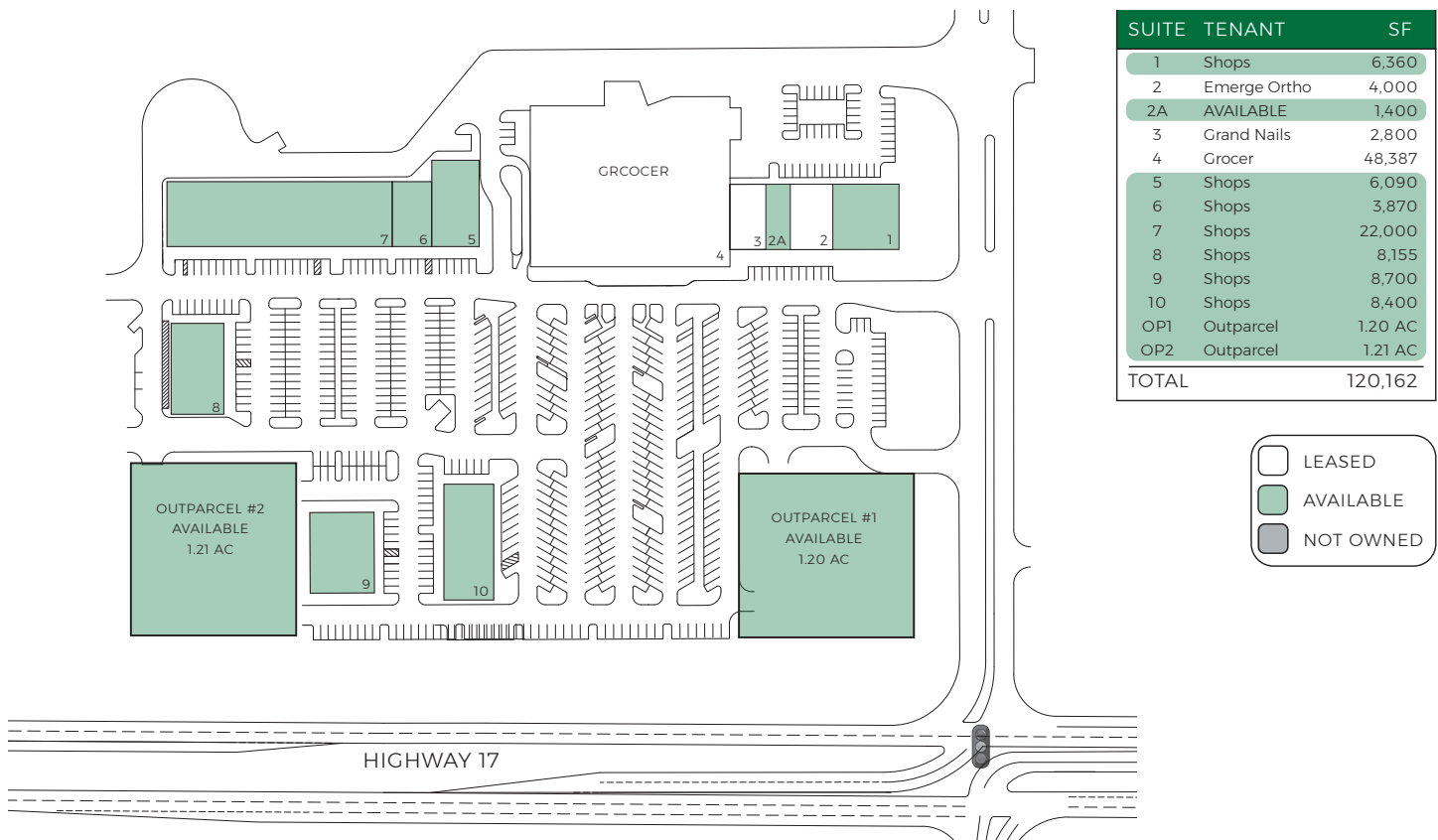

SHOPS AT SAVANNAH BRANCH

HIGHWAY 17, LELAND, BRUNSWICK COUNTY, NC 28451

DEMOGRAPHICS

	5 MINS	10 MINS	15 MINS
POPULATION	5,137	28,563	64,968
HOUSEHOLDS	2,240	12,049	28,189



Kris Murphy
 P: 678.460.3122
 E: kmurphy@columbiapropertiesinc.com
 www.columbiapropertiesinc.com

